



*Building Relationships since 1953.*

**HHS DR**  
Architects/Engineers

**HHS DR** is an experienced, regional leader in facility design and construction for the education, government, and private sectors.



**HHS DR** utilizes cloud-based technology to manage projects effectively out of our offices in Sharon and downtown Pittsburgh.

Our talented staff remains current with changes to codes and design standards, and integrates technology with a personal touch to add value to our clients' projects.



**HHS DR's** design and project management capabilities are substantial.

In 2016, we will design, bid and administer \$100 million in construction. Project types include regular building maintenance and capital improvements, additions to existing construction, new construction and repurposed space to meet the Owners' needs.



**HHS DR** is annually ranked #1 by the Pennsylvania Builders Exchange by volume of projects in design or under construction.

We build long-term relationships with our clients, providing them with responsive and high-quality service.



**We Build Relationships.**





*Building Relationships since 1953.*

**HHS DR**  
Architects/Engineers

**HHS DR is led by five Partners.**

Greer Hayden, Bob Englebaugh, Vincent Ordinario,  
Andreas Dometakis and Matt Franz.

**Our talented staff includes six Associates.**

Rob Schafer, Paul McCullough, John Carly,  
Jeff Tillia, Chuck Rozzi and Barbara Matejka.

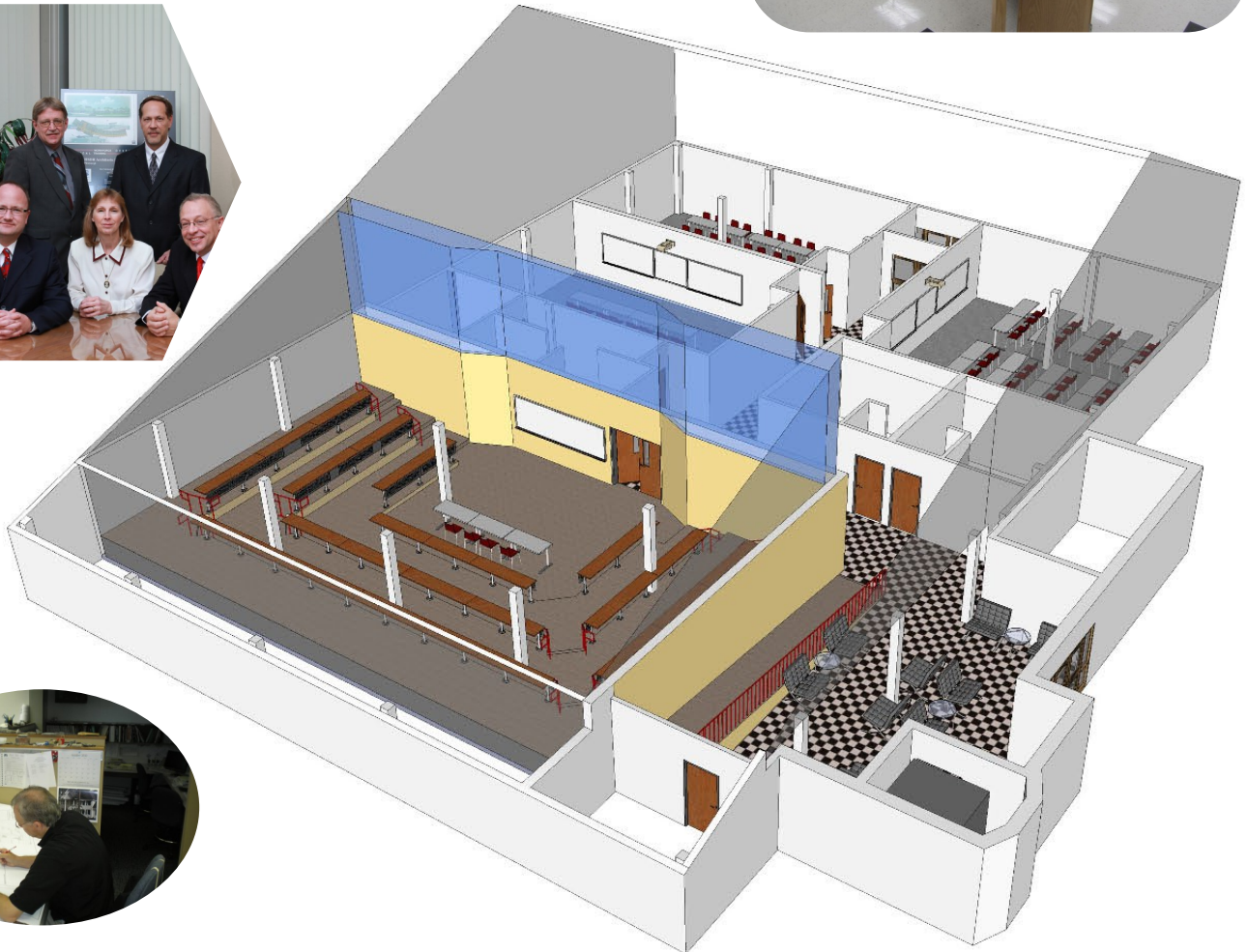

**We use technology efficiently to produce design solutions and to help communicate with clients and consultants.**

We *do not* use technology as a substitute for personal service, face-to-face communication, and being present on the job-site or in meetings with our clients.

**We Build Relationships.**



**HHS DR**  
Architects/Engineers

**HHS DR ARCHITECTS / ENGINEERS (HHS DR.COM)**

**ESTABLISHED 1953 / INCORPORATED 1971 IN PENNSYLVANIA.**

**LICENSED TO PRACTICE ARCHITECTURE AND ENGINEERING IN PENNSYLVANIA, OHIO AND WEST VIRGINIA.**

Hunter Heiges & Gross (1953)  
Hunter Heiges Sabo Douglass & Rogers (1971)

Hunter Heiges & Associates (1962)  
**HHS DR, INC. (1990)**

40 Shenango Avenue, Sharon, PA 16146-1502  
201 Century Building, 130 7<sup>TH</sup> Street, Pittsburgh, PA

**800.HHS DR.99**  
15222-3413

724.981.8820  
412.281.2280

724.981.4515 (f)  
412.281.2334 (f)



**OUR PARTNERS (CLOCKWISE FROM TOP LEFT)**

J. Greer Hayden, RA, PE, NCARB, President  
Robert A. Englebaugh, RA, Executive Vice President/Secretary  
Vincent M. Ordinario, RA, NCARB, Executive Vice President  
Matthew P. Franz, RA, NCARB, Vice President  
Andreas N. Dometakis, RA, NCARB, Vice President

**Relevant Projects**

*Alteration and Expansion of  
Butterfield Hall,  
Edinboro University*

*Porreco Center Campus Study,  
Edinboro University*

*New Art Sculpture Building,  
Slippery Rock University*

*Morrow Field House  
Collaboration Room,  
Slippery Rock University*

*Structural Remediation to  
Valley View Suites, Clarion University*

*Rose Hall Elevator Clock Tower Addition,  
Edinboro University*

**We Build Relationships.**





*Building Relationships since 1953.*

**HHS DR**  
Architects/Engineers

### **Pre-Design Services**

- Building Investigations
- Capital Improvements Forecasting
- Code Analysis
- Community Engagement / Design Charrettes
- Feasibility Studies
- Life-cycle Cost Analysis
- Master Planning / Land Development
- Programmatic Planning

### **Architect-of-Record / On-Call Services**

### **Construction Administration Services**

- Certify Pay Applications
- Chair Weekly Job Conference Meetings
- Collect Operation & Maintenance Manuals, Warranties and Close-out Documents
- Conduct Pre-Installation Meetings
- Manage Requests for Information
- Prepare and Administer Contracts
- Prepare Punch (Deficiency) Lists
- Review and Process Shop Drawings

### **Post-Construction Services**

### **Design Services**

- Architecture (new, renovation, sustainable)
- Athletic Facilities
- Budget Planning / Cost Estimating
- Interior Design and Graphics
- Landscape Architecture
- Project Sequencing and Scheduling
- Roofing Systems
- Site and Storm Water Management
- Specification Writing
- Structural Engineering
- Technology Systems

### **Special Services**

- Grant Assistance
- Leadership in Energy and Environmental Design
- Planning and Construction Workbook (PlanCon)
- 3-D Renderings / Modeling
- Site Studies
- Value Engineering

**We Build Relationships.**